

General Electric Company

Schenectady, N.Y.

NOVEMBER, 1923

BULLETIN NO. 54840

PARTS OF TYPE US-13 FORM E ROLLER BEARING TROLLEY BASE

Cat.No.	Description
501489	TYPE US-13 FORM E ROLLER BEARING TROLLEY BASE without pole
Following are the parts:-	
600341	STAND or FOOT with roller race and terminal
600342	Roller race for stand or foot (3.187 in. by 3.005 in. by 5 1/4 in.)
600343	Terminal
600351	Cap screw fastening terminal to stand or foot (3/8 in.-16, 5/8 in. hex.h.)
600403	Plate lock washer for No. 600351
600404	SWIVEL with roller raceway
600405	Roller raceway for swivel (2.31 in. by 2.499 in. by 5 1/2 in.)
601471	Axle pin bushing for swivel
601473	Lock shank (3/4 in. by 5 29/32 in.)
601472	Lock latch
601242	Lock rivet for Nos. 601472 and 601473 (3/16 in. by 1 1/8 in.)
600406	Screw for swivel (3/8 in.-16, 7/8 in. F.H.)
600407	Spring disk between swivel and stand or foot
601482	ROLLER CAGE with rollers, spacers and end plate
601481	Roller. Per set of 24. Cat.No. is for one roller
601479	End plate for roller cage
601480	Spacer for Cat. No. 601479
600410	Retaining screw for swivel (1 in.-8, 1 5/8 in. headless)
600411	Check nut for No. 600410 (1 in.-8, 1/2 in. thick, hex.)
600412	POLE SOCKET with clamp
600413	Pole socket body
600414	Clamp for pole socket
600415	Clamping bolt for clamp (3/4 in.-10, 3 in. sq.h. st'd)
600416	Nut for No. 600415 (3/4 in.-10, hex. st'd)

NOTE:-Data subject to change without notice.
SECOND EDITION

PARTS OF TYPE US-13 FORM E ROLLER BEARING TROLLEY BASE

Cat.No.	Description
601477	Pole socket axle pin (7/8 in. by 7 7/8 in.)
601492	Spring cotter for No. 601477 and swivel (3/16 in. by 2 1/4 in.)
600419	Shunt for pole socket body and swivel
600418	Washer for Nos. 601477 and 600419 (15/16 in. by 1 3/8 in. by 0.094 in.)
600172	Spring cotter for Nos. 601477 and 600418 (3/16 in. by 1 1/4 in.)
600420	Bolt fastening shunt to swivel (1/4 in.-20, 3/4 in. hex h.)
600005	Positive lock washer for No. 600420 (17/64 in. by 29/64 in. by 5/64 in.)
600421	Buffer spring
600422	Bolt for buffer spring (3/4 in.-10, 3 3/4 in. sq.h. sp'1)
600423	Washer for No. 600422 (13/16 in. by 2 1/4 in. by 1/8 in. thick)
600424	Nut for No. 600422 (3/4 in.-10, hex. sp'1)
600425	Spring cotter for No. 600422 (3/16 in. by 1 5/8 in.)
600426	Tension spring
600427	Spring adjusting bracket
600428	Spring holder bolt
600429	Washer for No. 600428 (11/16 in. by 1 3/4 in. by 0.102 in.)
600425	Spring cotter for No. 600428 (3/16 in. by 1 5/8 in.)
600430	Adjusting screw for No. 600427
600416	Check nut for No. 600430 (3/4 in.-10, hex. st'd)

54840-3
 PARTS OF TYPE US-13 FORM E ROLLER BEARING TROLLEY BASE

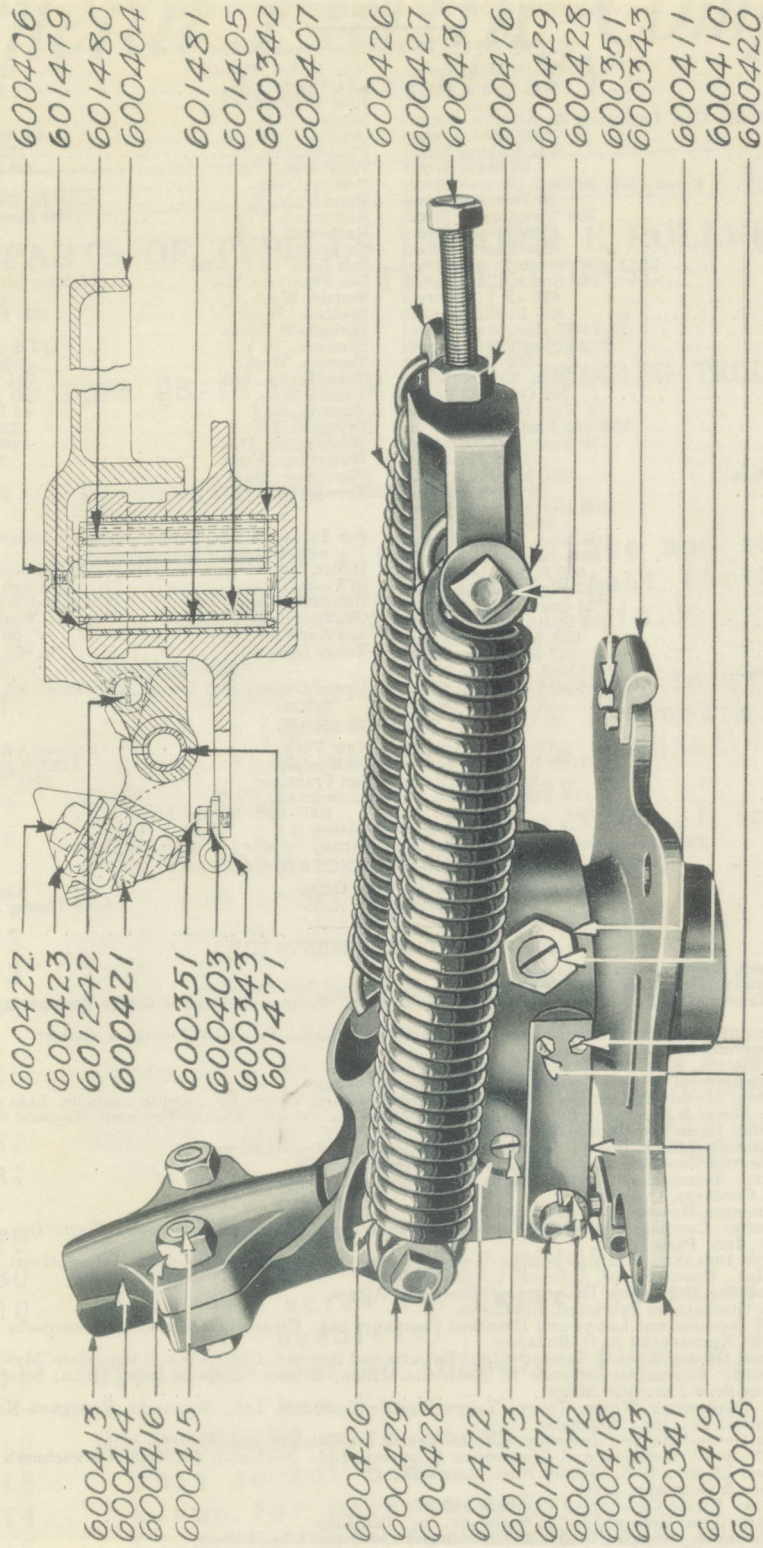

Type US-13 Form E Roller Bearing Trolley Base

GENERAL ELECTRIC COMPANY

GENERAL OFFICE: SCHENECTADY, N. Y.

SALES OFFICES (Address nearest Office)

Akron, Ohio.....	159 South Main Street	New Haven, Conn.....	129 Church Street
Atlanta, Ga.....	123 Spring Street	New Orleans, La.....	921 Canal Street
Baltimore, Md.....	Lexington Bldg., Cor. Lexington & Liberty Streets	New York, N. Y.....	120 Broadway
Birmingham, Ala.....	2000 First Avenue	Niagara Falls, N. Y.....	201 Falls Street
Bluefield, W. Va.....	104 Federal Street	Omaha, Neb.....	401 South 16th Street
Boston, Mass.....	84 State Street	Philadelphia, Pa.....	1321 Walnut Street
Buffalo, N. Y.....	Room 1100, 39 East Genesee Street	Pittsburgh, Pa.....	529 Smithfield Street
Butte, Mont.....	40 East Broadway	Portland, Ore.....	329 Adler Street
Canton, Ohio.....	700 Tuscarawas Street	Providence, R. I.....	76 Westminster Street
Chattanooga, Tenn.....	729 Broad Street	Richmond, Va.....	700 East Franklin Street
Charleston, W. Va.....	201 Capitol Street	Rochester, N. Y.....	130 Main Street
Charlotte, N. C.....	200 South Tryon Street	St. Louis, Mo.....	112 North 4th Street
Chicago, Ill.....	230 South Clark Street	Salt Lake City, Utah.....	10 Exchange Place
Cincinnati, Ohio.....	630-42 Vine Street	San Francisco, Cal.....	116 New Montgomery Street
Cleveland, Ohio.....	925 Euclid Avenue	Seattle, Wash.....	811 First Avenue
Columbus, Ohio.....	73-87 East State Street	Spokane, Wash.....	425 Riverside Avenue
Dayton, Ohio.....	25 North Main Street	Springfield, Mass.....	387 Main Street
Denver, Colo.....	809 17th Street	Syracuse, N. Y.....	113 South Salina Street
Des Moines, Iowa.....	904 West Walnut Street	Tacoma, Wash.....	950 Pacific Avenue
Detroit, Mich.....	701 Griswold Street	Terre Haute, Ind.....	701 Wabash Avenue
Duluth, Minn.....	14 West Superior Street	Toledo, Ohio.....	520 Madison Avenue
Elmira, N. Y.....	338-342 East Water Street	Trenton, N. J.....	45 East State Street
Eric, Pa.....	10 East Twelfth Street	Utica, N. Y.....	239 Genesee Street
Port Wayne, Ind.....	1635 Broadway	Washington, D. C.....	1405 G Street N.W.
Grand Rapids, Mich.....	201 Monroe Avenue	Waterbury, Conn.....	195 Grand Street
Hartford, Conn.....	18 Asylum Street	Worcester, Mass.....	340 Main Street
Indianapolis, Ind.....	106 North Illinois Street	Youngstown, Ohio.....	44 Central Square
Jackson, Mich.....	109 Francis Street		
Jacksonville, Fla.....	108 West Forsyth Street		
Kansas City, Mo.....	1004 Baltimore Avenue		
Knoxville, Tenn.....	602 South Gay Street		
Little Rock, Ark.....	223 West Second Street		
Los Angeles, Cal.....	724 South Spring Street		
Louisville, Ky.....	455 South Fourth Street		
Memphis, Tenn.....	130 Madison Avenue		
Milwaukee, Wis.....	217 Sycamore Street		
Minneapolis, Minn.....	410 Third Avenue, North		
Nashville, Tenn.....	234 Third Avenue, North		
Newark, N. J.....	671 Broad Street		

For Texas, Oklahoma and Arizona Business refer to South-west General Electric Co.
 Dallas, Tex..... 1801 North Lamar Street
 El Paso, Tex..... 206 San Francisco Street
 Houston, Tex..... Third and Washington Streets
 Oklahoma City, Okla..... 1 West Grande Avenue
 San Antonio, Tex..... 601 Navarro Street
 Tulsa, Okla..... 403 Cosden Building

Motor Dealers and Lamp Agencies in all large cities and towns.

SERVICE SHOPS

Atlanta.....	18 Stewart Avenue	New York.....	Greenwich & Morton Streets
Chicago.....	509 E. Illinois Street	Philadelphia.....	1223 Washington Avenue
Eric.....	East Lake Road	San Francisco.....	17th & Kansas Streets
Minneapolis.....	410 Third Avenue, N.	Schenectady, N. Y.....	1 River Road
St. Louis.....	1007-1009 Spruce Street		

Distributors for the General Electric Company outside of the United States
 INTERNATIONAL GENERAL ELECTRIC COMPANY, INC.

New York City
 120 Broadway

General Sales Offices
 Schenectady, N. Y.

London
 Crown House, Aldwych, W.C. 2

AGENTS AND REPRESENTATIVES

ARGENTINA: General Electric, S. A., Buenos Aires
 AUSTRALIA: Australian General Electric Company, Ltd., Sydney and Melbourne
 AUSTRIA: Joh. Kremenezky Fabrik Für Elektrische Glühlampen, Vienna; Elektrische Glühlampenfabrik "Watt" A. G., Vienna
 BELGIUM AND COLONIES: Societe d'Electricite et de Mecanique (Procedes Thomson-Houston & Carels) Societe Anonyme, Brussels, Belgium
 BRAZIL: General Electric, S. A., Rio de Janeiro and Sao Paulo
 CANADA: Canadian General Electric Company, Ltd., Toronto, Ontario
 CHILE: International Machinery Company, Santiago, Antofagasta and Valparaiso; Nitrate Agencies, Ltd., Iquique
 CHINA: Andersen, Meyer & Company, Ltd., Shanghai. International General Electric Company (General Office for the Far East excluding Japan and China), Shanghai
 COLOMBIA: Wesselhoef & Poor, Bogota, Barranquilla, Medellin and Bucaramanga
 CUBA: General Electric Company of Cuba, Havana and Santiago
 DUTCH EAST INDIES: International General Electric Company, Inc., Soerabaia, Java
 ECUADOR: Carlos Cordovez, Guayaquil
 EGYPT: British Thomson-Houston Company, Ltd., Cairo
 FRANCE AND COLONIES: Compagnie Francaise Thomson-Houston, Paris; Compagnie des Lampes, Paris; International General Electric Co., Inc., Paris
 GREAT BRITAIN AND IRELAND: British Thomson-Houston Company, Ltd., Rugby, England; International General Electric Company, Inc., Crown House, Aldwych, London, W. C. 2
 GREECE AND COLONIES: Compagnie Hellenique d'Electricite, Athens
 HOLLAND: Philips Gloeilampen Fabrieken, Eindhoven
 HUNGARY: United Incandescent Lamps and Electrical Company, Ltd., Ujpest, near Budapest; Ungarische Wolframlampen Fabrik—Joh. Kremenezky A. G. Budapest
 INDIA: International General Electric Company, Inc., Calcutta and Bombay, Cawnpore and Bangalore, Mysore
 ITALY AND COLONIES: Compagnia Generale Di Elettricit, Milan; Fabrica Lampade Itala, Milan; Societa Edison per la Fabbricazione delle Lampade, Milan
 JAPAN: Shibaura Engineering Works, Tokyo; Tokyo Electric Company, Ltd., Kawasaki, Kanagawa-Ken; International General Electric Co., Inc., Yokohama
 MEXICO: Mexican General Electric Company, City of Mexico, Guadalajara and Monterey
 NEW ZEALAND: National Electrical and Engineering Company, Ltd., Auckland, Dunedin, Christchurch and Wellington
 PARAGUAY: General Electric, S. A., Buenos Aires, Argentina
 PERU: W. R. Grace & Company, Lima
 PHILIPPINE ISLANDS: Pacific Commercial Company, Manila
 PORTO RICO: International General Electric Company, Inc., San Juan
 PORTUGAL AND COLONIES: Sociedad Iberica de Construccoes Electricas, Lda., Lisbon
 RUSSIA: Wseobshchaia Electriceskaja Kompania, Petrograd and Vladivostok
 SOUTH AFRICA: South African General Electric Company, Ltd., Johannesburg and Capetown
 SPAIN AND COLONIES: Sociedad Iberica de Construcciones Electricas, Madrid and Barcelona
 URUGUAY: General Electric, S. A., Montevideo
 VENEZUELA: Wesselhoef & Poor, Caracas